



HDF Cane Touch Apron for Heavy-Duty Drinking Fountain

GENERAL

The cane touch apron is an optional accessory designed to bring the bottom of bi-level units into line with each other to give a sense of symmetry and to satisfy customer preference. For use on Halsey Taylor Heavy-Duty Contour™ series units. When installed properly all HDF Units meet ADA requirements without the cane apron. Standard finish is 14 gauge heavy-duty stainless steel. Overall Dimensions: 11 15/16" W x 6" H x 18" D.

Note: Floor to underside measurements of cane apron equals 27" when mounted correctly. 24" (610mm) for child ADA.

KIT CONSISTS OF:

- 14 gauge stainless steel cane apron
- 14 gauge stainless steel bottom cover plate
- Vandal-resistant screws
- Installation instructions

Use part #HDFCANE when ordering.

NOTE: Continued product improvement makes specifications subject to change without notice. See Halsey Taylor website for most current spec sheet.

Cane Touch Apron



**HDF Cane Apron shown installed on
Halsey Taylor Model HDFBLEBP**

JOB NAME: _____

ENGINEER/CONTRACTOR NAME:

APPROVAL: _____

DATE: _____

HDF Cane Touch Apron for Heavy Duty Drinking Fountain

(CONTINUED)

INSTALLATION INSTRUCTIONS FOR HEAVY DUTY CANE APRON KIT

INSTALLATION PROCEDURE:

- 1) Remove screws and bottom cover plate from fountain. Discard bottom cover plate.
- 2) Attach item 1 (Cane Apron Assy.) to bottom of fountain with six screws previously removed.
- 3) Attach new bottom cover plate (Item 2) to cane apron assy. with supplied screws (Item 3).

PARTS LIST		
ITEM NO.	PART NO.	DESCRIPTION
1	28566C	Cane Apron Assy.
2	28556C	Bottom Cover
3	75570C	Screw - #10 x .50 Pinned Torx
NS	75520C	Bit - Pinned Torx T-25

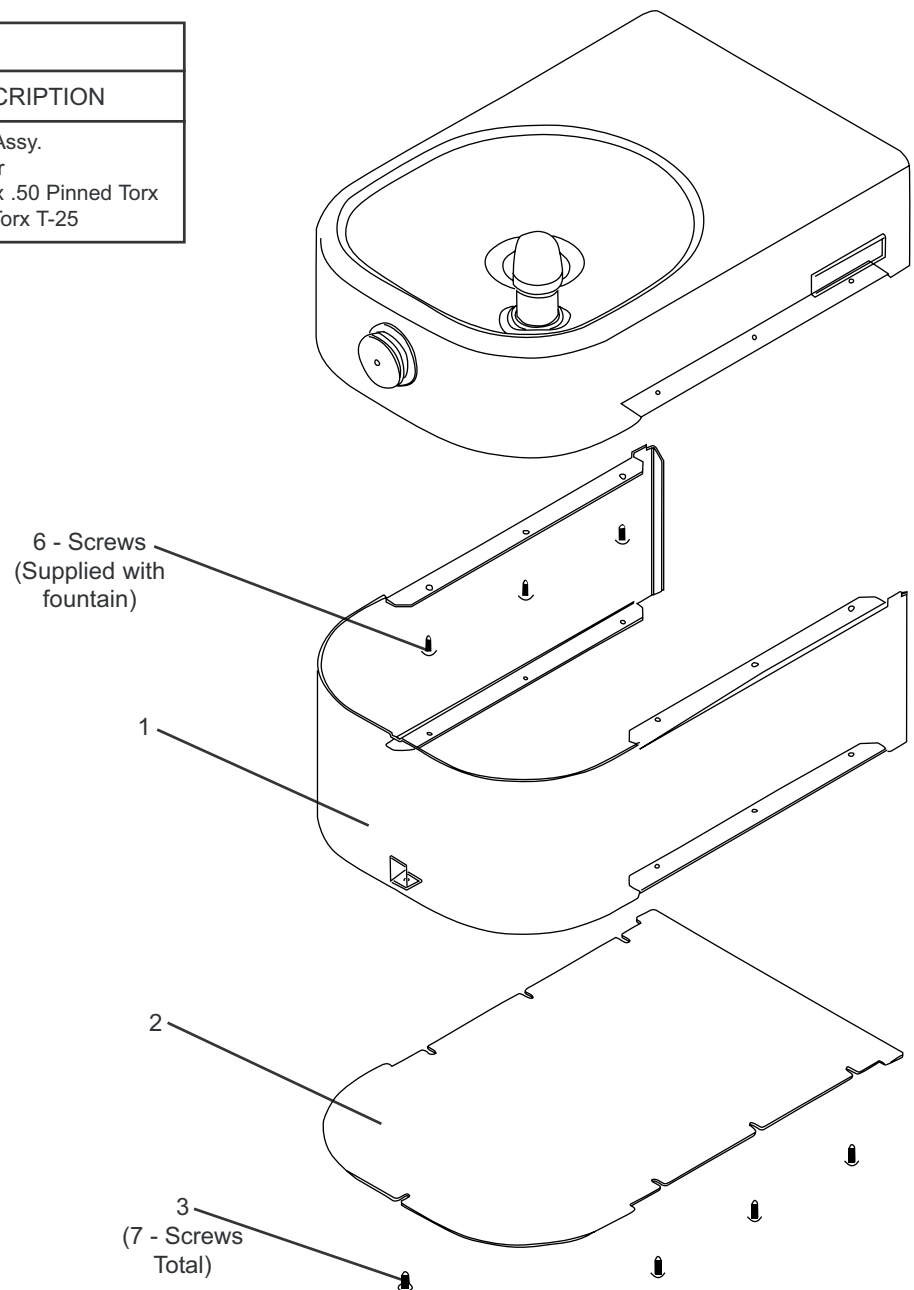

Halsey Taylor®